

DAM614

DIGITAL MATRIXES

Installation Digital Mixer



PRODUCT OVERVIEW

DAM614 is a fully programmable audio digital mixer. It includes 6 audio inputs and 4 audio outputs, front panel inputs and outputs level controls, DSP processing, RS-232 connectivity and 4 REMOTE control ports (0-10VDC). Its 4 outputs can be used as mono independent zones or coupled as stereo zones. Regarding inputs, the first 2 are stereo LINE inputs, and the 3rd, 4th, 5th and 6th ones are MIC/LINE ready (phantom available), being possible to use them independently (mono) or as stereo-coupled inputs.

KEY FEATURES

- DSP @ 24 bits / 48kHz
- Front panel LCD display
- 6 front panel input control digital knobs (one per input)
- 4 front panel output control digital knobs (one per output)
- 4 front panel keys, for parameters adjustment and menu navigation
- Processing:
 - Independent level control for each input and output
 - Independent mixer for each output zone
 - Crossover filters available for each output
 - Independent 10 band graphic EQ for each output
 - Independent and adjustable High-pass filter available for MIC/LINE inputs
 - 2 level priority PAGER / DUCKER function, triggered by MIC/LINE inputs
 - Independent Noise Gate function for MIC/LINE inputs
 - Independent Feedback Suppressor Function for MIC/LINE inputs
 - Adjustable delay time for 2 outputs

APPLICATIONS

- A/V corporate, retail and education applications
- BGM & Paging solutions, with message priorities and source/volume independent selection
- Conferencing
- P.A. management (multi-way speaker processing, delay adjustment, etc.)

ACCESSORIES AND COMPATIBLE PRODUCTS

- MPAGE1
- MPAGE4
- WPa Series



WPaVOL-SR



MPAGE4

MECHANICAL DIAGRAMS

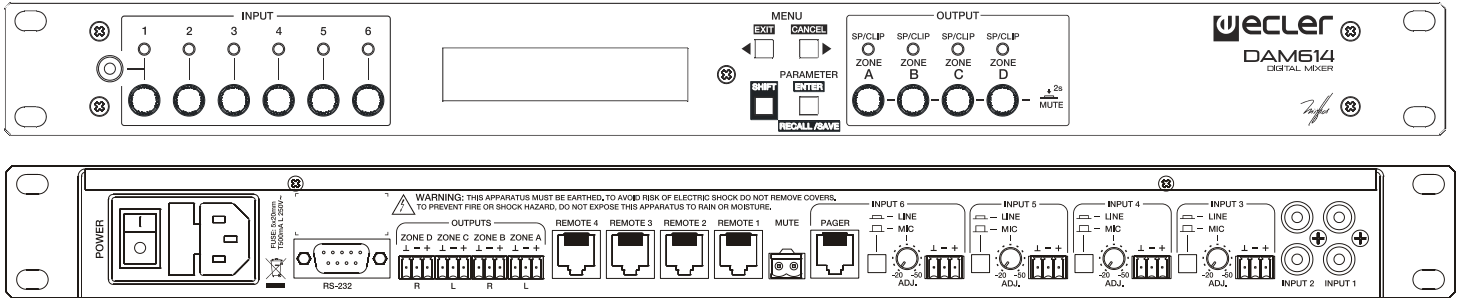

TECHNICAL DATA

INPUT 1, 2 (LINE)

Sensitivity	0 / -6dBV Internal jumper adjust. 0dBV factory default
Input impedance	>13k
Input connector	RCA female

INPUT 3, 4, 5, 6 (MIC)

Sensitivity	-20 / -50dBV External potentiometer adjust
Input impedance	>24k electronically balanced
CMRR	>55dB (20Hz ÷ 20kHz)
Input connector	Terminal block (Symmetrical)
Phantom	18VDC (Internal jumper)

INPUT 3, 4, 5, 6 (LINE)

Sensitivity	0 / -6dBV Internal jumper adjust. 0dBV factory default
Input impedance	>24k electronically balanced
CMRR	>55dB (20Hz ÷ 20kHz)
Input connector	Terminal block (Symmetrical)
Phantom	18VDC (Internal jumper)

ZONE OUTPUTS

Nominal output level	0dBV
Output impedance	300Ω electronically balanced
Output connector	Terminal block (Symmetrical)

A/D & D/A	24bit / 48kHz
FREQUENCY RESPONSE	<10Hz ~ 20kHz (+0dB/ -0.5dB)
OUTPUT NOISE FLOOR (FFT)	>110dB (from 20Hz to 20kHz)
THD + NOISE	< 0.0058% (1kHz, 1Vrms)
CROSSTALK	>90dB, 20Hz ÷ 20kHz

INPUT EQ

Type	Baxandall 3 ways EQ
Gain	-10dB ~ +10dB in 0.1dB steps
Frequency	Low 200Hz Mid 1kHz High 6.3kHz

INPUT 3, 4, 5, 6 TALKOVER EQ

Type	Assignable to any output zone. 2 priority levels
Modes	Ducker / Pager (only input 6)
Threshold	-80 / +12dBV
Depth	0 ~ 80dB
Attack time	5 ~ 2000ms

Hold time	10 ~ 3000ms
Release time	50 ~ 3000ms
Chime (only input 6)	ON / OFF. Variable volume. Two different melodies
INPUT 3, 4, 5, 6 NOISE GATE	
Threshold	-80 / +12dBV
Depth	0 ~ 80dB
Attack time	0.1 ~ 500ms
Hold time	10 ~ 3000ms
Release time	10 ~ 1000ms
INPUT 3, 4 OTHER OPTIONS	
Feedback supressor	Frequency shifter type.
High pass filter (hum & pop suppressor)	50 ~ 150 Hz 12dB/oct Butterworth
ZONE OUTPUT EQ	
Type	10 band EQ
Filters	Adaptable Q to achieve maximum flat response
Gain	-10dB ~ +10dB step 0.1dB
Frequencies	31, 63, 125, 250, 500, 1k, 2k, 4k, 8k, 16k Hz
ZONE OUTPUT CROSSOVER FILTERS	
Type	Low & High Pass Butterworth 12 dB/oct
Frequency	20Hz ÷ 20kHz
ZONE OUTPUT COMPRESSOR	
Threshold	-36 / +12dBV
Ratio	1:1 ~ 1:inf (LIMITER)
Knee	Hard / Soft
Attack time	0.1 ~ 500ms
Release time	10 ~ 1000ms
Make-up gain	0dB ~ +10dB
ZONE OUTPUT DELAY	
Delay Time	10 ~ 1000ms (10 ~ 343,4m)
Units	Milliseconds, seconds, centimeters, meters
EXTERNAL MUTE	
Configuration	Normally open. Assignable to any output zone
REMOTE CONTROLS	
Remote type	WPmVOL-SR. Up to 4 remotes
Configuration	Input volume Zone volume Input selector Preset selector
GENERAL	
Mains	90+264VAC 50/60Hz
Power consumption	20VA
Dimensions WxHxD	482.6x44x120mm
Weight	2.00kg